



St. Georges Court
Residents Parking Only

St Georges Court, St. Georges Road, Addlestone, KT15 2AY





Offered to the market with no onward chain, this charming one-bedroom ground-floor apartment is located within a sought-after over 55's (women) and over 60's (men) development in the heart of Addlestone, just a short walk from local amenities.

The apartment features a bright and airy living room with French doors that open directly onto the communal gardens, perfect for enjoying the outdoors.

There is a spacious double bedroom with fitted wardrobes and a well-equipped kitchen—both offering pleasant views of the surrounding gardens.

A fully tiled wet room with contemporary white sanitary ware, a spacious double bedroom, and a well-equipped kitchen—both offering pleasant views of the gardens.

Additional benefits of St George's Court include visitor and resident parking, a house manager available Monday to Friday, and a 24-hour careline system in both the apartments and communal areas and potential for brand new 99 year lease.



Leasehold

Approximate Area = 449 sq ft / 42 sq m

For identification only - Not to scale

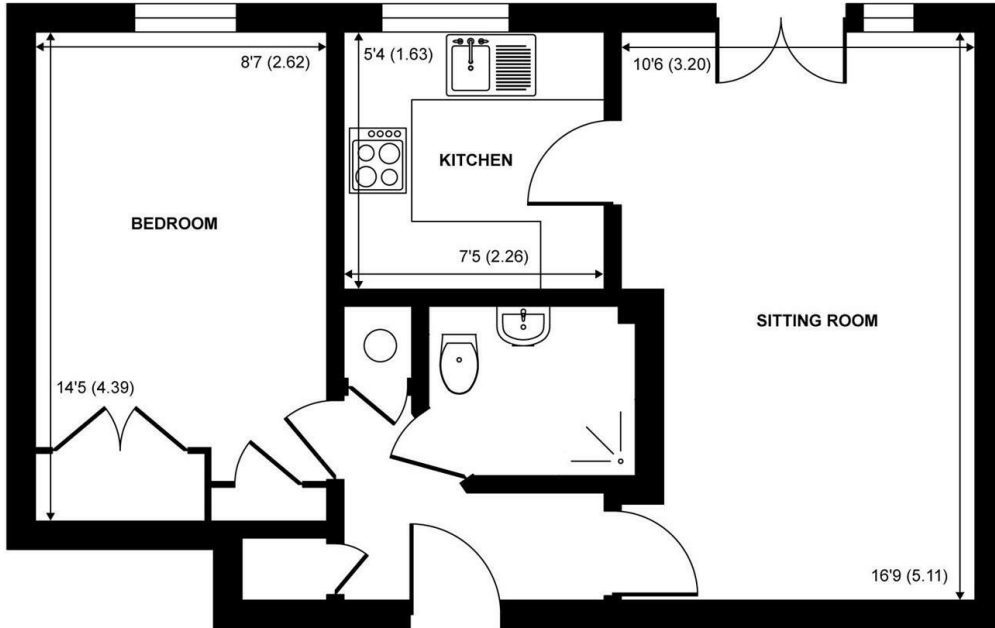

EPC Rating: 79 C





Grants Homes 60 Church Street, Weybridge, Surrey, KT13 8DL
T: 01932 858885 E: addestone@grantshomes.co.uk

